

Premises Licence

Premises Licence Number:

PREM 793

Part 1 - Premises Details

Postal address of Premises or, if none, ordnance survey map reference or description:

Aldeli
Tower Buildings
Wilmslow Road
Alderley Edge
Cheshire

Post Town: Alderley Edge

Post Code: SK9 7QB

Telephone Number: 01625 585709

Where the Licence is time limited, the dates:

Not applicable

Licensable activities authorised by the Licence:

Live Music
Recorded Music
Sale and supply of alcohol

The times the Licence authorises the carrying out of licensable activities:

Live Music

Monday to Saturday 08:00 to 23:00 hours
Sunday 10:00 to 22:00 hours

The performance of live music will take place indoors.

Recorded Music

Monday to Saturday 08:00 to 23:00 hours
Sunday 10:00 to 22:00 hours

The playing of recorded music will take place indoors.

Sale and supply of alcohol

Monday to Saturday 11:00 to 23:00 hours
Sunday 11:00 to 22:00 hours

The opening hours of the Premises:

Monday to Saturday 08:00 to 23:00 hours
Sunday 10:00 to 22:00 hours

Where the Licence authorises supplies of alcohol, whether these are on and/or off supplies:

The sale of alcohol shall be for consumption on the premises only.

Part 2

Name, (registered) address, telephone number and email (where relevant) of holder of Premises Licence:

Aldeli LLP
Tower Buildings
London Road
Alderley Edge
Cheshire
SK9 7QB

Tel No: 01625 587509

Registered number of holder, for example company number, charity number (where applicable):

Not known

Name, address and telephone number of designated Premises Supervisor where the Premises Licence authorises for the supply of alcohol:

Personal Licence number and issuing authority of Personal Licence held by designated Premises Supervisor where the Premises Licence authorises for the supply of alcohol:

Personal Licence Number: PERS1515

Issuing Authority: Cheshire East

Signed by Mrs N Cadman on behalf of
Cheshire East Borough Council

Issued on 12th July 2012

Annex 1 - Mandatory Conditions

1. No supply of alcohol may be made under this Premises Licence –

- (a) at a time when there is no designated premises supervisor in respect of the Premises Licence, or
- (a) at a time when the designated premises supervisor does not hold a Personal Licence or his Personal Licence is suspended.

2. Every supply of alcohol under this Premises Licence must be made or authorised by a person who holds a Personal Licence.

LICENSING ACT 2003 (MANDATORY LICENSING CONDITIONS) ORDER 2010

MANDATORY CONDITIONS

Condition 1

(1) The responsible person shall take all reasonable steps to ensure that staff on relevant premises do not carry out, arrange or participate in any irresponsible promotions in relation to the premises.

(2) In this paragraph, an irresponsible promotion means any one or more of the following activities, or substantially similar activities, carried on for the purpose of encouraging the sale or supply of alcohol for consumption on the premises in a manner which carries a significant risk of leading or contributing to crime and disorder, prejudice to public safety, public nuisance, or harm to children—

(a) games or other activities which require or encourage, or are designed to require or encourage, individuals to—

(i) drink a quantity of alcohol within a time limit (other than to drink alcohol sold or supplied on the premises before the cessation of the period in which the responsible person is authorised to sell or supply alcohol), or

(ii) drink as much alcohol as possible (whether within a time limit or otherwise);

(b) provision of unlimited or unspecified quantities of alcohol free or for a fixed or discounted fee to the public or to a group defined by a particular characteristic (other than any promotion or discount available to an individual in respect of alcohol for consumption at a table meal, as defined in section 159 of the Act);

(c) provision of free or discounted alcohol or any other thing as a prize to encourage or reward the purchase and consumption of alcohol over a period of 24 hours or less;

(d) provision of free or discounted alcohol in relation to the viewing on the premises of a sporting event, where that provision is dependent on—

(i) the outcome of a race, competition or other event or process, or

(ii) the likelihood of anything occurring or not occurring;

(e) selling or supplying alcohol in association with promotional posters or flyers on, or in the vicinity of, the premises which can reasonably be considered to condone, encourage or glamorise anti-social behaviour or to refer to the effects of drunkenness in any favourable manner.

Condition 2

The responsible person shall ensure that no alcohol is dispensed directly by one person into the mouth of another (other than where that other person is unable to drink without assistance by reason of a disability).

Condition 3

The responsible person shall ensure that free tap water is provided on request to customers where it is reasonably available.

Condition 4

(1) The premises licence holder or club premises certificate holder shall ensure that an age verification policy applies to the premises in relation to the sale or supply of alcohol.

(2) The policy must require individuals who appear to the responsible person to be under 18 years of age (or such older age as may be specified in the policy) to produce on request, before being served alcohol, identification bearing their photograph, date of birth and a holographic mark.

Condition 5

The responsible person shall ensure that—

(a) where any of the following alcoholic drinks is sold or supplied for consumption on the premises (other than alcoholic drinks sold or supplied having been made up in advance ready for sale or supply in a securely closed container) it is available to customers in the following measures—

- (i) beer or cider: ½ pint;
 - (ii) gin, rum, vodka or whisky: 25 ml or 35 ml; and
 - (iii) still wine in a glass: 125 ml; and
- (b) customers are made aware of the availability of these measures.

Annex 2 - Conditions consistent with the Operating Schedule

Prevention of Crime and Disorder

1. There shall be digital CCTV installed, where the recorded images are kept for 28 days and can be kept for Police use.
2. There shall be permanent exterior lighting.
3. Excess stock shall be locked away.

Public Safety

4. Fire exits and extinguishers shall be maintained.
5. Anti bandit windows shall be installed throughout.
6. Emergency lighting and fire alarms shall be installed.

Prevention of Public Nuisance

7. Sound levels at the premises shall be carefully monitored to prevent noise being heard outside.
8. There shall be plenty of car parking available.
9. The bins shall not be emptied between 23:00 and 07:00 hours.

Protection of Children from Harm

10. Challenge 25 shall be adopted to safeguard children from underage sales.
11. There shall be due diligence to stop under age sales and refusal book shall be used.

Annex 3 - Conditions attached after a hearing by the Licensing Authority

1. Sound levels shall be monitored at the boundary of the nearest neighbouring property from 9pm each evening so that music being played is such that it cannot be heard above the general street noise beyond that boundary
2. The outside seating shall not be used after 9pm
3. The Designated Premises Supervisor (not the performer(s)) shall at all times have control of the amplification of live music.
4. Bottles shall not be disposed of outside the hours of 9pm and 9am.

Annex 4 - Plans

See attached.



Licensing Act 2003 – Premises Licence

Duration of a Premises Licence

A premises licence has effect until such a time that it is suspended, revoked or surrendered.

Duty to notify change of name or address

The holder of a premises licence must, as soon as is reasonably practicable, notify the relevant licensing authority of any change of name or address.

Where the designated premises supervisor (DPS) under a premises licence is not the holder of the licence, he should notify the licensing authority of a change in name or address as soon as possible. The DPS must also notify the holder of the premises licence.

Failure without reasonable excuse to comply with the above is an offence, and a person will be liable on summary conviction to a fine not exceeding level 2 on the standard scale (ie £500)

Duty to keep and display licence

The holder of a premises licence must ensure that the licence or a certified copy of it is kept at the premises in the custody of or under the control of the holder of the licence or a person who works at the premises whom the premises licence holder has nominated in writing. A notice should be prominently displayed at the premises specifying the position of any such nominee.

The premises licence holder has a duty to ensure that a summary of the licence or a certified copy of that summary is prominently displayed at the premises.

Failure without reasonable excuse to comply with the above is an offence, and a person will be liable on summary conviction to a fine not exceeding level 2 on the standard scale (ie £500)

Duty to produce licence

A constable or an authorised person may require production of the premises licence for examination. An authorised person must, if requested, produce evidence of his authority to exercise the power.

Failure without reasonable excuse to comply with the above is an offence, and a person will be liable on summary conviction to a fine not exceeding level 2 on the standard scale (ie £500)

Theft or loss of premises licence

Where a premises licence or summary is lost, stolen, damaged or destroyed, the holder of the licence may apply to the relevant licensing authority for a copy of the licence or summary. A fee of £10.50 is payable in relation to such an application.

Where an application is made for a replacement licence or summary the licensing authority must issue the holder of the licence with a licence or summary if it is satisfied that –

- (a) the licence or summary has been lost, stolen, damaged or destroyed; and
- (a) where it has been lost or stolen, the holder has reported that loss or theft to the police.

Surrender of premises licence

Where the holder of a premises licence wishes to surrender his/her licence he/she may give the licensing authority a notice to that effect. The notice must be accompanied by the premises licence, or where that is not practicable, by a statement of the reasons for the failure to provide the licence. Where a notice of surrender is given, the premises licence lapses on receipt of the notice by the licensing authority.

Death, incapacity, insolvency of licence holder

A premises licence lapses if the holder of the licence –

- (a) dies,
- (a) becomes mentally incapable (within the meaning of section 13(1) of the Enduring Powers of Attorney Act 1985)
- (b) becomes insolvent,
- (c) is dissolved, or
- (d) if it is a club, ceases to be a recognised club

(subject to provision for re-instatement in certain circumstances).

Floor Plan of Albeli

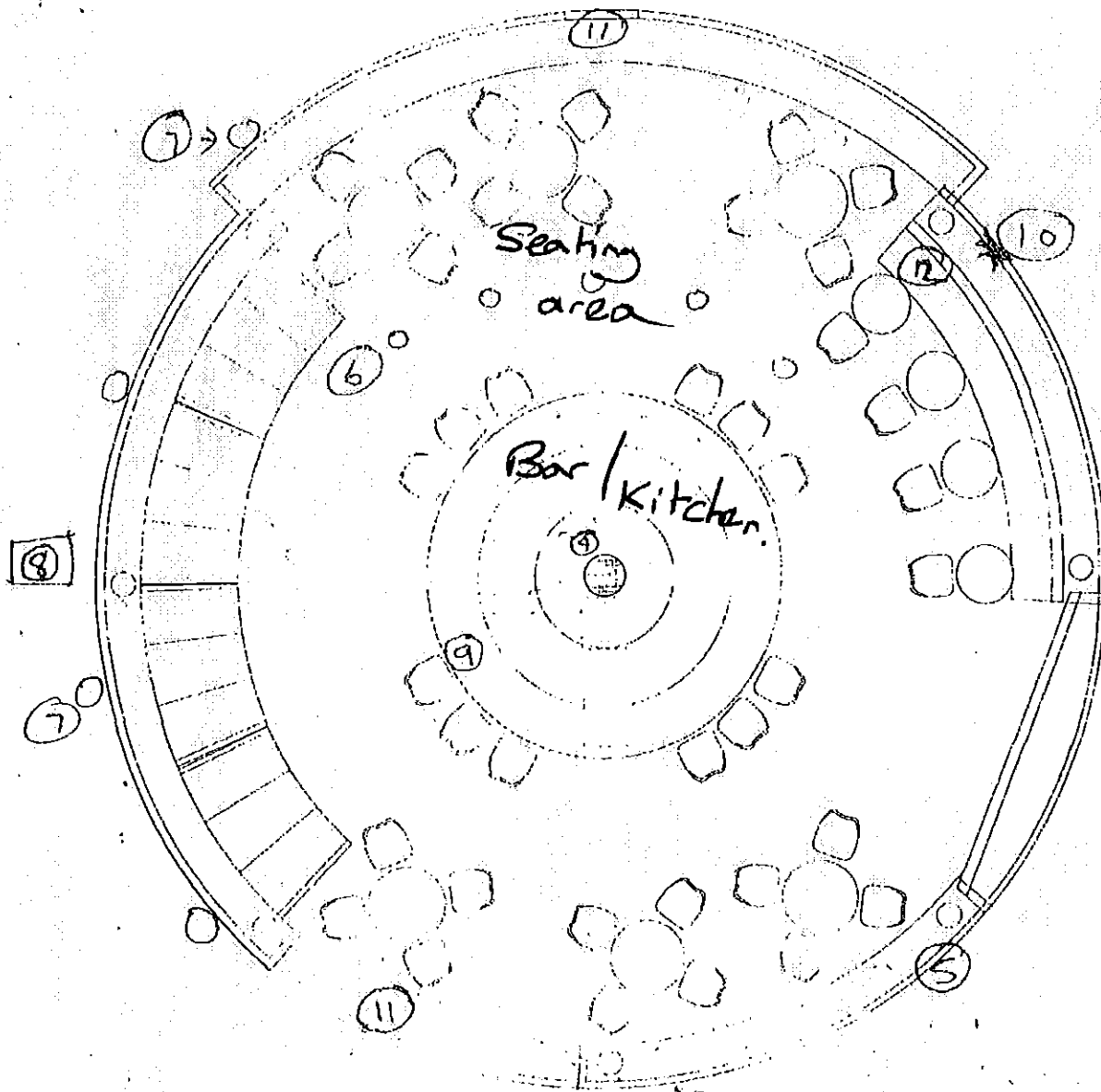

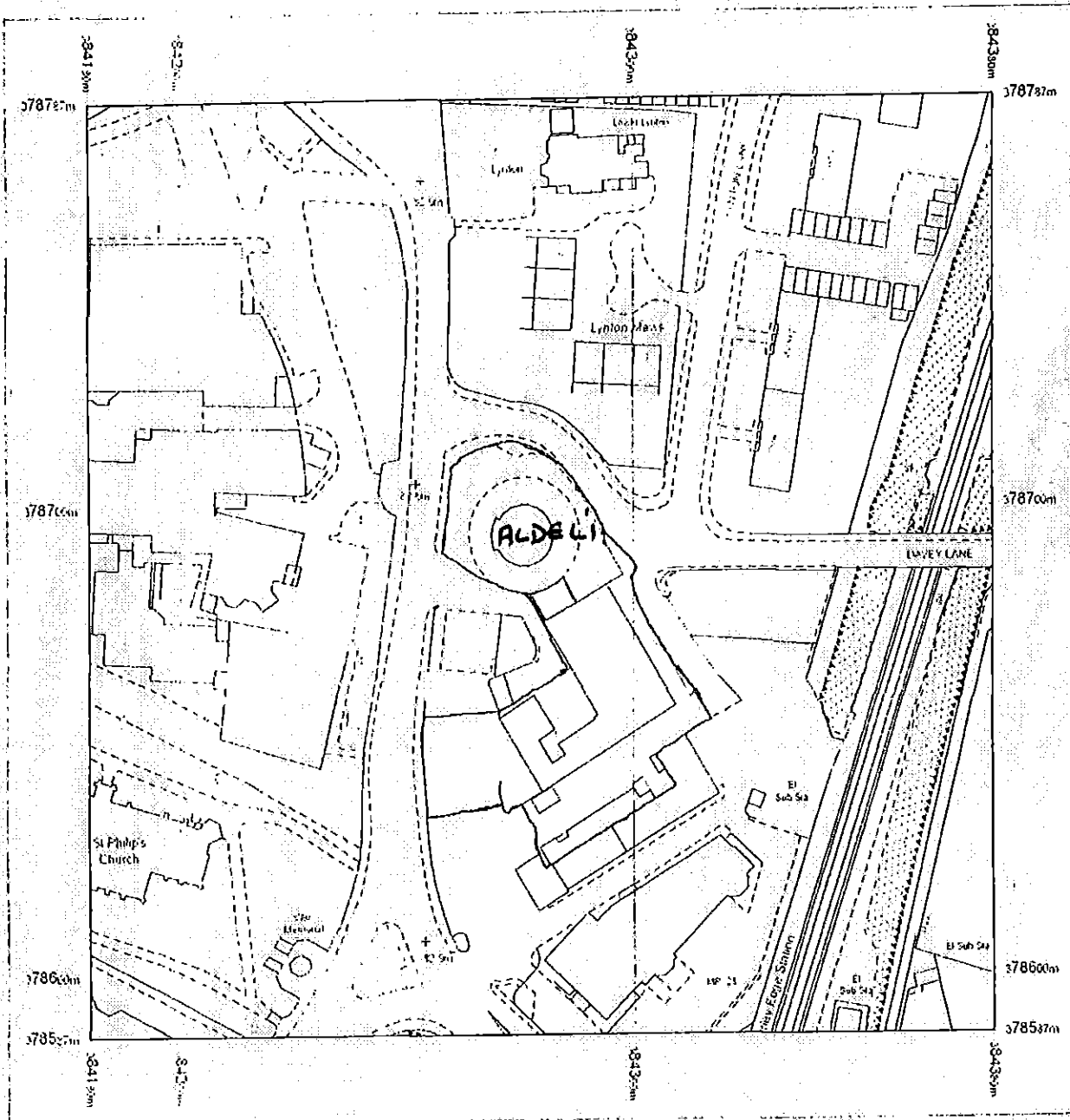

Produced 14 07 2011 from the Ordnance Survey National Geographic Database and incorporating surveyed features available at this date. © Crown Copyright 2011

Reproduction in whole or part is prohibited without the prior permission of Ordnance Survey.

Ordnance Survey, the OS Symbol and OS Sitemap are registered trademarks of Ordnance Survey, the national mapping agency of Great Britain.

The representation of a road track or path is no evidence of a right of way.

The representation of features as lines is no evidence of a property boundary.

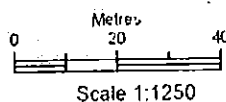

Supplied by **Latitude - Southampton**
Serial number 04623000
Centre coordinates 384279 75 378686 75

Further information can be found on the OS Sitemap Information booklet or the Ordnance Survey web site www.ordnancesurvey.co.uk